



# WIRED REMOTE CONTROLLER

## INSTALLATION MANUAL

English

Français

Español

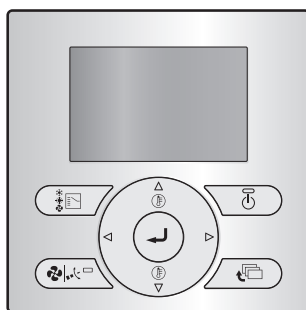

**BRC073A6**

**Be sure to read this installer reference guide  
before conducting the installation of this product.**

# Contents

1. Safety Considerations .....	2
2. Accessories .....	5
3. User interface installation procedure .....	5
4. Functions and menu items of the user interface buttons .....	12
5. Power-on .....	15
6. Field settings .....	16
7. Test operation method (pair split only) .....	18
8. Checking procedure of Error History .....	22
9. Registration method of the Maintenance Contact information .....	23
10. Confirmation of registered details .....	24
11. Clock & Calendar .....	25
12. Language .....	26
13. Prohibit Buttons .....	27
14. Function Prohibition .....	28
15. Prohibit Mode .....	29



# 1. Safety Considerations

The original instructions are written in English. All other languages are translations of the original instructions.

## ■ Also see the installation manual attached to the indoor unit.

**Please read these Safety Considerations carefully before installing the user interface.**

- This manual classifies the precautions into WARNING and CAUTION. They both contain important information regarding safety. Be sure to follow all the precautions below.

 <b>WARNING</b>	Failure to follow these instructions properly may result in personal injury or loss of life.
 <b>CAUTION</b>	Failure to observe these instructions properly may result in property damage or personal injury, which may be serious depending on the circumstances.

- After completing the installation, conduct a trial operation to check for faults and explain to the customer how to operate the air conditioner with the aid of the User reference guide. Ask the customer to store the Installer reference guide along with the User reference guide for future reference.

 **WARNING**

<p>Ask your dealer or qualified personnel to carry out installation work. Do not attempt to install the user interface yourself. Improper installation may result in water leakage, electric shocks or fire.</p>
<p>Consult your local dealer regarding relocation and reinstallation of the user interface. Improper installation work may result in leakage, electric shocks or fire hazards.</p>
<p>Install the user interface in accordance with the instructions in this Installer reference guide. Improper installation may result in water leakage, electric shocks or fire.</p>
<p>Be sure to use only the specified accessories and parts for installation work. Failure to use the specified parts may result in the unit falling down, water leakage, electric shocks or fire.</p>
<p>Install the user interface on a foundation strong enough to withstand the weight of the user interface. Insufficient strength may result in the user interface falling down and causing injury.</p>
<p>Electrical work must be performed in accordance with the relevant local and national regulations and with the instructions in this Installer reference guide. Be sure to use a dedicated power supply circuit only. Insufficient power circuit capacity and improper workmanship may result in electric shocks or fire.</p>
<p>Always perform installation work with the power turned off. Touching electric parts may result in electric shock.</p>
<p>Do not disassemble, reconstruct or repair. This may result in electric shock and/or fire.</p>
<p>Make sure that all wiring is secured, the specified wires are used and that there is no strain on the terminal connections or wires. Improper connections or securing of wires may result in abnormal heat build-up or fire.</p>
<p>The choice of materials and installations must comply with the applicable national and international standards.</p>

## CAUTION

To avoid leakage and electric shock due to entry of water or insects, fill the wiring through hole with putty.

To avoid electric shocks, do not operate with wet hands.

Do not wash the user interface with water, as this may result in electric shocks or fire.

Install the indoor and outdoor units, power cord and connection wires at least 3.3ft (1m) away from televisions or radios to prevent interference and noise.

(Depending on the incoming signal strength, a distance of 3.3ft (1m) may not be sufficient to eliminate noise.)

Do not install the air conditioner in the following locations:

1. Where there is a high concentration of mineral oil spray or vapor (e.g. a kitchen).  
Plastic parts may deteriorate and fall off which could result in water leakage.
2. Where corrosive gas, such as sulphurous acid gas, is produced.  
Corroding of copper pipes or soldered parts may result in refrigerant leakage.
3. Near machinery emitting electromagnetic radiation.  
Electromagnetic radiation may disturb the operation of the control system and result in malfunctioning of the unit.
4. Where flammable gas may leak, where there is carbon fiber or ignitable dust suspensions in the air or where volatile flammables such as paint thinner or gasoline are handled.  
Operating the unit in such conditions may result in fire.
5. High temperature areas or direct flames.  
Overheating and/or fire may occur.
6. Moist areas or places which may be exposed to water.  
If water enters the user interface, electric shock may be caused and the inner electronics may fail.

When the thermostat function of the user interface is used, select the installation location while considering it should be a place:

- Where the average temperature in the room can be detected.
- Which is not exposed to direct sunlight.
- Which is not near a heat source.
- Which is not affected by the outside air or air draught due to, for example, opening/closing of doors, the air outlet of the indoor unit or the like.
- Which is NOT located outdoors.

## 2. Accessories

Not included but required: BRCW901A\*.

Item No.	Length
BRCW901A03	10ft
BRCW901A08	26ft

## 3. User interface installation procedure

### 3-1 Determine where to install the user interface.

Make sure to follow "1. Safety Considerations" when determining the location.

### 3-2 Make a wiring through hole on the wall if the wires are coming out from the rear.

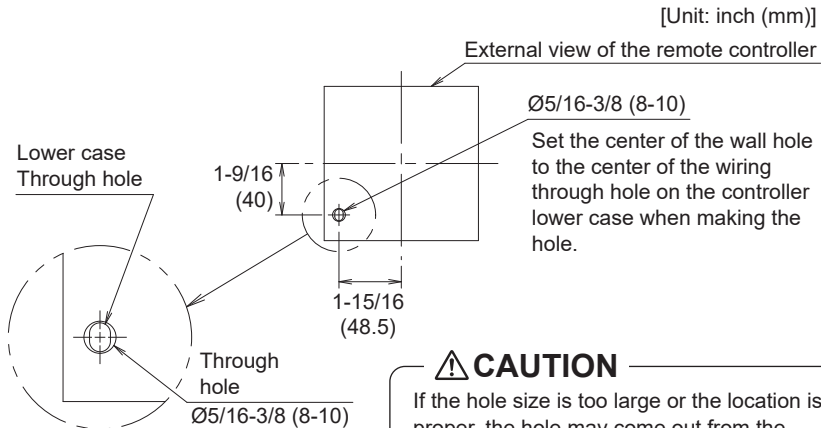

### ⚠ CAUTION

If the hole size is too large or the location is not proper, the hole may come out from the controller.

### 3-3 Remove upper case.

Insert a screwdriver in the recess of lower case to remove the upper case (2 points).

Remote controller printed-circuit board is installed on the upper case. Be careful not to damage the printed-circuit board with the screwdriver.

Be careful not to let dust or moisture touch the printed-circuit board.

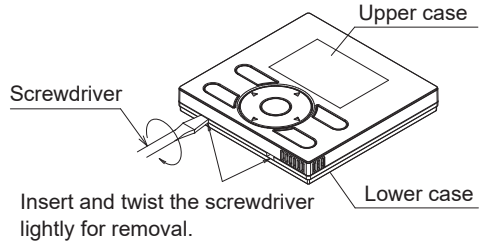

### 3-4 Determine the direction of the controller wiring outlet (rear outlet, left outlet, top left outlet).

#### 3-4-1 Rear outlet

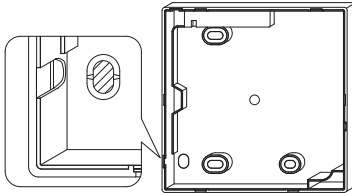

Cut off the resin area (hatched area).

#### 3-4-2 Left outlet

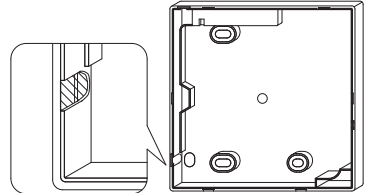

Cut off the thin area (hatched area) with nippers or the like and then remove the burrs with a file or the like.

#### 3-4-3 Top left outlet

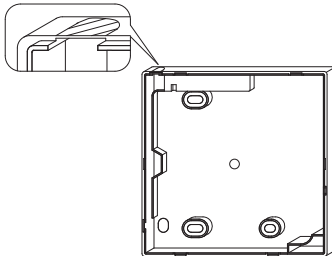

Cut off the thin area (hatched area) with nippers or the like and then remove the burrs with a file or the like.

### 3-5 Securing the user interface adapter.

Remove the upper case of the user interface adapter and secure the lower case assembly.

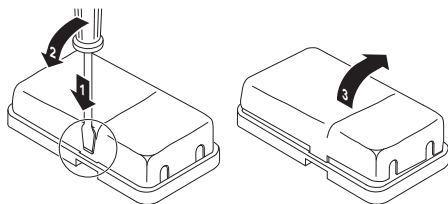

Mounting with supplied wood screws

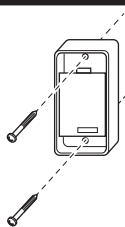

Mounting with supplied double-face adhesive tape

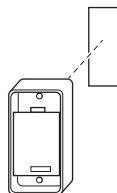

## 3-6 Conduct wiring.

### 3-6-1 Connections overview

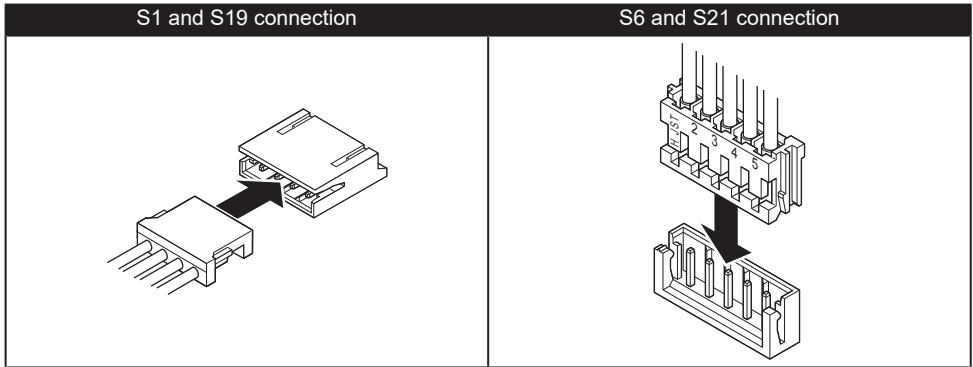

### 3-6-2 Rear outlet

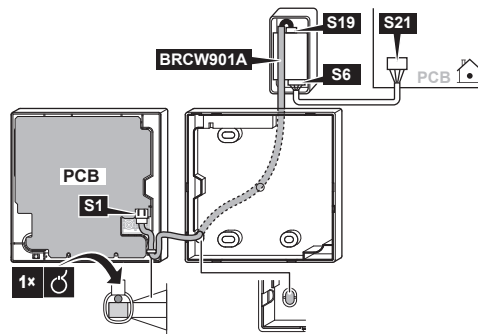

### 3-6-3 Left outlet

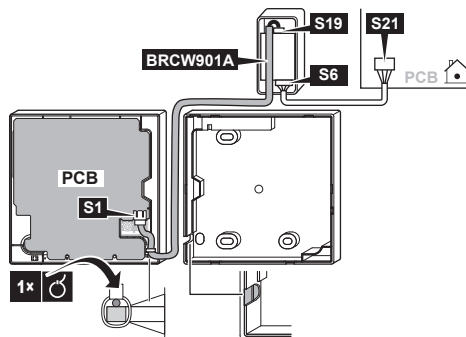

### 3-6-4 Top left outlet

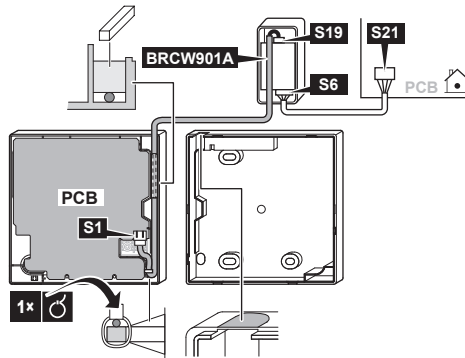

#### **⚠ CAUTION**

- Do not perform wiring close to a power line in order to avoid electrical noise (external noise).
- Seal the wiring draw-in port securely with putty (field supply) to prevent the entry of insects or the like.

#### **⚠ CAUTION**

- The adapter does not provide any form of strain release. The installer must provide something to release the strain on the cables near the adapter.

#### **ⓘ NOTICE**

- Ground both ends of the BRCW901A\* option cable.

### 3-7 Fixing procedure of the lower case.

In the case of wiring a user interface through the rear outlet, perform the wiring through the outlet hole in the lower case before it is installed on the wall.

#### 3-7-1 Wall mounting

Secure by using furnished wood screws (2 pcs.).

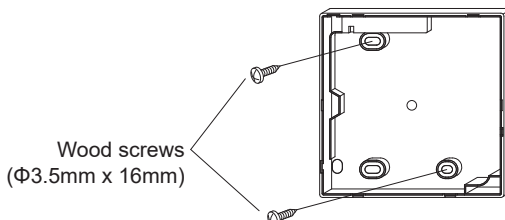

### 3-7-2 Switchbox mounting

Secure by using furnished small screws (2 pcs).

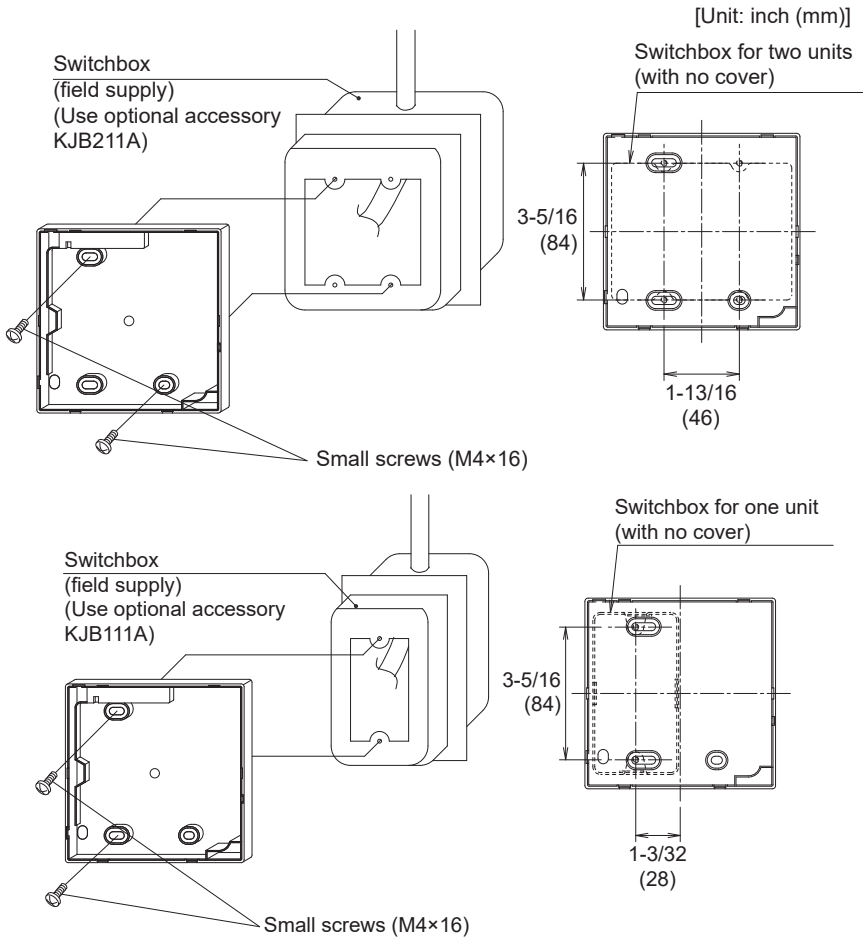

#### ⚠ CAUTION

- Select a flat surface for installation if possible.
- Do not tighten the installation screws too much to avoid deforming the lower case.

### 3-8 Attach the upper case.

- Align the upper case with the tabs of the lower case (6 points) and insert the upper case.
- Be careful not to pinch the wiring when attaching.
- Peel off the protective seal which is attached to the upper case.

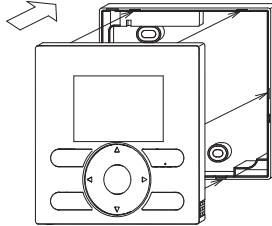

# 4. Functions and menu items of the user interface buttons

## 4-1 Functions and menu items

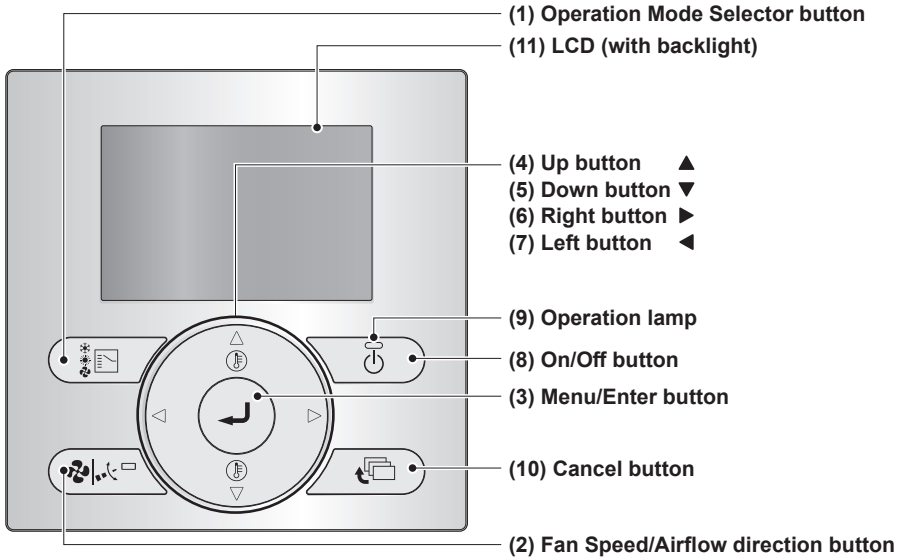

- (1) Operation Mode Selector button**
- This button is enabled by default. To disable, refer to ["13. Prohibit Buttons" on page 27](#).
  - Press this button to select the operation mode of your preference.
  - Available modes may vary with the connected model.

- (2) Fan Speed/Airflow direction button**
- Used to change the fan speed and airflow direction.
  - Available fan speeds and airflow directions may vary with the connected model.

- (3) Menu/Enter button**
- This button is enabled by default. To disable, refer to ["4-2 Enable/disable the Menu/Enter and Cancel button" on page 14](#).
  - Used to display the main menu or enter the selected item. (For details on the main menu, see the User reference guide.)

**Main menu\***

Airflow Direction
Energy Saving Options
Schedule
Maintenance Information
Configuration
Current Settings
Clock & Calendar
Language

- (4) Up button ▲**
- Used to raise the set temperature.
  - The next item on the upper side will be highlighted.  
(Keep pressing the button to cycle through the values or items.)
  - Used to change the selected item.

**(5) Down button ▼**

- Used to lower the set temperature.
- The next item on the lower side will be highlighted.  
(Keep pressing the button to cycle through the values or items.)
- Used to change the selected item.

**(6) Right button ►**

- Used to highlight the next item on the right-hand side.
- The display contents are changed to the next screen.

**(7) Left button ◀**

- Used to highlight the next items on the left-hand side.
- The display contents are changed to the previous screen.

**(8) On/Off button**

- Press to start or stop the air conditioner.

**(9) Operation lamp (Green)**

- This lamp lights up during operation.
- This lamp will blink if an error or mode conflict occurs.
- This lamp is not lit when the unit operation is OFF.

**(10) Cancel button**

- Used to return to the previous screen.
- Press and hold this button for 4 seconds or longer to display the Service Settings menu.

**(11) LCD (with backlight)**

- The backlight will be lit for approximately 30 seconds when one of the buttons is pressed.
- The actions linked to the buttons, except for the On/Off button, are not carried out when the backlight is not lit.

**Service Settings menu\***

Test Operation\*\*  
Maintenance Contact  
Field Settings  
Error History

\*Available menu items are depending on the connected model.

\*\*Not displayed in case of multi-split setup.

**⚠ CAUTION**

- To operate the Up/Down/Left/Right button, always press ▲, ▼, ◀, or ►.

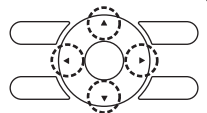

## 4-2 Enable/disable the Menu/Enter and Cancel button

To disable the Menu/Enter and Cancel button in the Basic screen, proceed as follow:

1. Keep the ► button pressed.
2. Push the 3 indicated keys simultaneously while keeping the ► button pressed.

To enable the Menu/Enter and Cancel button in the Basic screen, follow the same procedure.

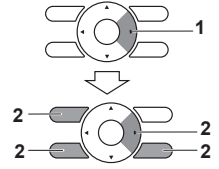

## 4-3 Description of button operation

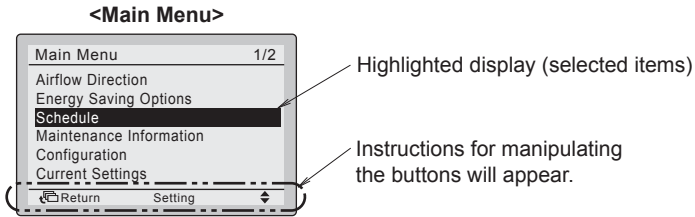

## 5. Power-on

- Check that the indoor/outdoor unit wiring is completed.
- Check that the switchbox cover of the indoor and outdoor units are closed before powering on.

### Split air conditioner is connected to a user interface

- 5-1** Turn on the power.
- 5-2** "Checking the connection.  
Please stand by." is displayed.

#### <Main user interface>

**5-2**

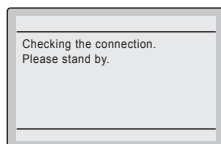

#### <Basic screen>

- 5-3** The Basic screen is displayed.

**5-3**

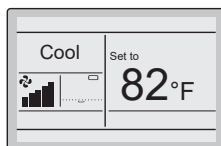

### NOTE

When the text on the left is displayed, the backlight does not light up when one of the buttons is pressed.

### NOTE

- When selecting a different language, refer to ["12. Language" on page 26](#).
- The displayed operation mode on the user interface at first startup depends on the operation mode of the indoor unit.

## 6. Field settings

**6-1** Press and hold the Cancel button for 4 seconds or longer. The Service Settings menu is displayed.

**6-1**

<Basic screen>

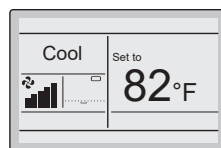

<Service Settings>

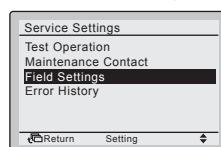

<Field settings>

**6-2** Select **Field Settings** and press the Menu/Enter button.

**6-2**

**6-3** Highlight the "Mode No.", and select the desired "Mode No." by using the ▲▼ (Up/Down) buttons. For the most commonly used field settings, refer to page 17.

**6-3**

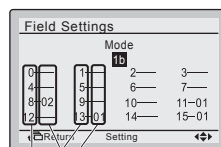

SECOND CODE NO.  
FIRST CODE (SW) NO.

- The current settings are displayed.
- CODE NO. " -- " means that there is no function available.

**6-4** Highlight the SECOND CODE NO. of the FIRST CODE NO. to be changed and select the desired SECOND CODE NO. by using the ▲▼ (Up/Down) buttons. Multiple identical mode number settings are available.



Press the Menu/Enter button.



**6-5** Press the Menu/Enter button. The confirmation screen is displayed.

**6-5**

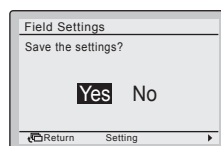

<Field Settings>

**6-6** Select **Yes** and press the Menu/Enter button. The settings are saved and the Field settings screen returns.

**6-6**

- 6-7** After all changes are completed, press the Cancel button twice.
- 6-8** The backlight goes out and "Checking the connection. Please stand by" is displayed during initialization. After the initialization, the Basic screen returns.

Mode No.	First Code No.	Description of the setting	Second code No.			
			01	02	03	04
1b	8	Daylight Saving Time	Disable	Enable*	—	—
	11	(Private use)	NA*	NA	—	—
	13	Basic screen display	Icon+Text*	Icon	—	—
	15	(Private use)	NA*	NA	—	—
1c	0	(Private use)	NA	NA*	—	—
	2	(Private use)	NA	NA*	—	—
	4	(Private use)	NA	NA*	—	—
	5	(Private use)	NA*	—	—	—
	6	(Private use)	NA*	—	—	—
1e	14	(Private use)	NA*	NA	—	—
	1	(Private use)	NA	NA*	—	—
	2	Setback function	Do not use	Heat only	Cool only	Cool and Heat*
	5	(Private use)	NA	NA*	—	—
	6	(Private use)	NA	NA*	—	—
	8	(Private use)	NA*	—	—	—
	9	(Private use)	NA	NA*	—	—
a	(Private use)	NA*	—	—	—	

\* Factory default setting

# 7. Test operation method (pair split only)

\* In case of multi-split models, see the manual attached to the outdoor unit.

## NOTE

- In case of multi-split setup, test operation cannot be used.

**Also see the installation manuals attached to the indoor unit and the outdoor unit.**

- Check that the wiring of the indoor unit and the outdoor unit is completed.
- Check that the switchbox cover of the indoor unit and the outdoor unit is closed.
- Perform the test operation according to the following procedure.

## NOTE

- The backlight will be lit for approximately 30 seconds when pressing one of the operation buttons.
- Operate the buttons only when the backlight is lit. However, the On/Off button can be operated when the backlight is not lit.

**7-1** Make sure the electric work is properly completed and proper voltage is available before turn on the power.

## CAUTION

Make sure that the outer panel and piping cover are closed before operation (danger of electric shock).

**7-2** Confirm that both the liquid and gas stop valves are opened.

**7-3** Set the operation mode to cooling by using the Operation Mode Selector button.

**7-4** Press and hold the Cancel button for 4 seconds or longer. The Service Settings menu is displayed.

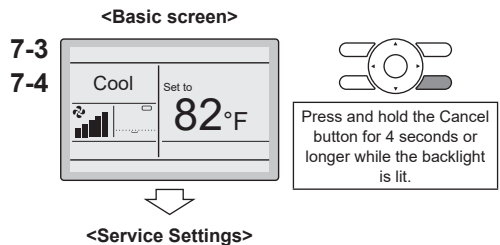

**7-5** Select **Test Operation** and press the Menu/Enter button. The Basic screen returns and "Test operation" is displayed.

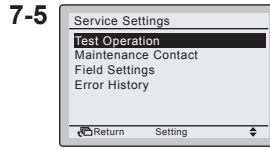

Press the Menu/Enter button.

**7-6** Press the On/Off button within about 10 seconds. Test operation starts. Check the operation condition for 3 minutes.

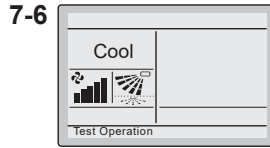

Press the On/Off button (within 10 seconds).

**NOTE**

Test operation can also be started by first performing 7-6, followed by 7-5.

**7-7** Press the Menu/Enter button in the Basic screen. The Main menu is displayed.

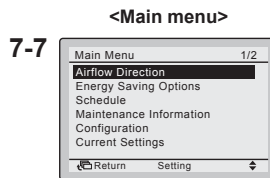

Press the Menu/Enter button.

**7-8** Select **Airflow Direction** and press the Menu/Enter button.

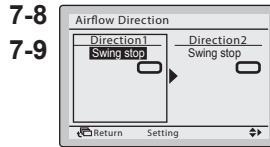

Change the airflow direction using the ▲▼ (Up/Down) buttons.

**7-9** Press the ▲▼ buttons to select the desired airflow direction and press the Menu/Enter button. The Basic screen returns.

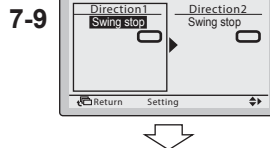

Press the Menu/Enter button.

**7-10** Press and hold the Cancel button for 4 seconds or longer in the Basic screen. The Service Settings menu is displayed.

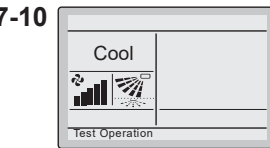

Press and hold the Cancel button for 4 seconds or longer while the backlight is lit.

<Service Settings menu>

**7-11** Select **Test Operation** in the Service Settings menu and press the Menu/Enter button. The Basic screen returns and normal operation is possible.

**7-11**

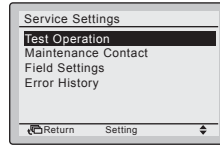

Press the Menu/Enter button.

<Basic screen>

**7-12** Check the functions according to the User reference guide.

**7-13** When the decoration panel is not installed, turn off the power after test operation finishes.

## NOTE

Test operation will automatically finish after 30 minutes.

## CAUTION

- If the interior work is not completed when the test operation is finished, explain to the customer that he should not operate the unit until the interior work is completed in order to protect the indoor unit.
- (If the indoor unit is operated, the indoor unit may be contaminated with the materials which arise from paints or adhesives during the interior work and water splash or water leak may occur.)

## CAUTION

- If it is not possible to operate the unit due to any malfunction, refer to **Malfunction diagnosis method**.
- When the test operation finishes, check that the error code history is not displayed in the Maintenance Information screen according to the following procedure.

**7-14** Press the Menu/Enter button in the Basic screen. The Main menu is displayed.

**7-14**

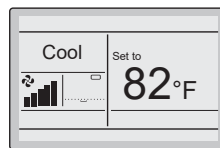

Press the Menu/Enter button.

<Basic screen>

<Main menu>

**7-15** Select **Maintenance Information** and press the Menu/Enter button.

**7-15**

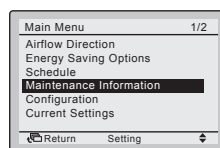

Press the Menu/Enter button.

**7-16** The Maintenance Information screen is displayed. Check that the last error code is not displayed in the screen.

**7-17** If the last error code is displayed, conduct the malfunction diagnosis referring to "Error code list" in the installation manual of the indoor unit. After the malfunction diagnosis finishes, press and hold the On/Off button for 4 seconds or longer in the "Maintenance Information" screen to erase the error code history.

**7-16**  
**7-17**

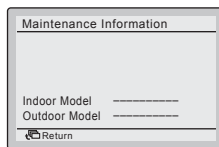

Press and hold the On/Off button for 4 seconds or longer.

## NOTE

If no error code is displayed when this procedure is followed, the system has completed the test operation normally.

## Malfunction diagnosis method

- When the user interface displays any item in the following table, inspect the details in the table.
- If an error occurs, "Error: Push Menu button" or "⚠" is displayed. Conduct the malfunction analysis referring to "Error code list" in the installation manual of the indoor unit. To see the RC Error History screen, refer to "[8. Checking procedure of Error History](#)".

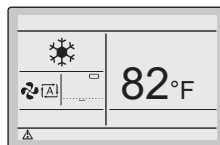
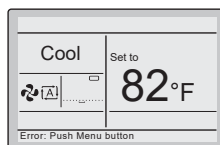



User interface display	Description
No display	<ul style="list-style-type: none"> <li>• Power outage, power voltage failure or open-phase</li> <li>• Wrong wiring (between indoor and outdoor units)</li> <li>• Indoor PCB assembly failure</li> <li>• User interface wiring disconnection</li> <li>• User interface failure</li> <li>• Blown fuse (outdoor unit)</li> </ul>
Display "Checking the connection Please stand by" is shown.*	<ul style="list-style-type: none"> <li>• Indoor PCB assembly failure</li> <li>• Wrong wiring (between indoor and outdoor units)</li> </ul>

\* Though "Checking the connection Please stand by" is displayed for up to 180 seconds after powering on, this does not mean there is a failure. (Determine after 180 seconds if error code "U5" is displayed.)

# 8. Checking procedure of Error History

**8-1** Press and hold the Cancel button for 4 seconds or longer in the Basic screen. The Service Settings menu is displayed.

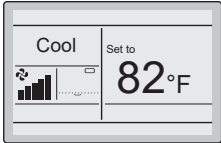

**8-1** **<Basic screen>**

Press and hold the Cancel button for 4 seconds or longer while the backlight is lit.

**8-2** Select **Error History** and press the Menu/Enter button. The Error History menu is displayed.

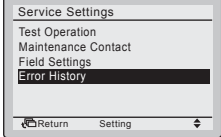

**8-2** **<Service Settings>**

Press the Menu/Enter button.

**8-3** Select **RC Error History** and press the Menu/Enter button. The error codes can be confirmed in the RC Error History screen.

**8-3** **Error History**

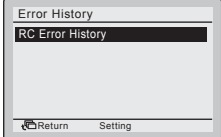



Press the Menu/Enter button.

**8-4** In the RC Error History screen the last 10 items are displayed in order.

**8-4** **RC Error History** 1/3

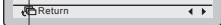
Error	Date	Time
01	-/-/---	:-:--
02	-/-/---	:-:--
03	-/-/---	:-:--
04	-/-/---	:-:--



**8-5** Press the Cancel button in the RC Error History screen 3 times. The Basic screen returns.

Latest record

# 9. Registration method of the Maintenance Contact information

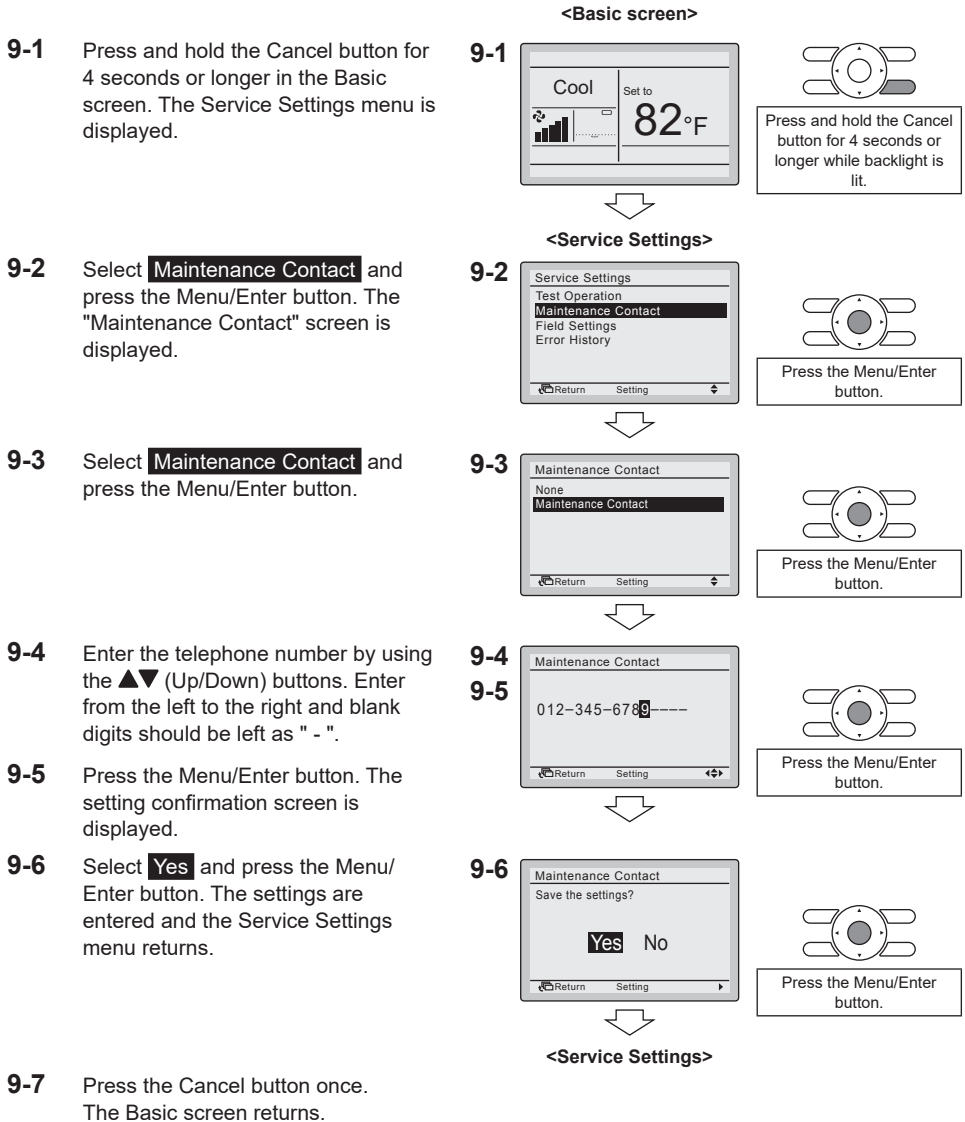

- Registration of the service contact information.



# 10. Confirmation of registered details

**10-1** Press the Menu/Enter button in the Basic screen. The Main menu is displayed.

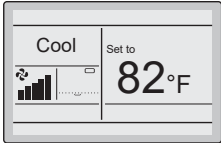

**10-1** **<Basic screen>**

Press the Menu/Enter button.

**10-2** Select **Maintenance Information** and press the Menu/Enter button. The "Maintenance Information" screen is displayed.

**10-2** **<Main menu>**

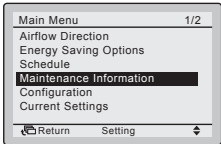
Press the Menu/Enter button.

**10-3** Confirm that the contact information is entered correctly.

**10-3** **Maintenance Information**

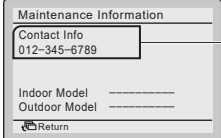

The registered details are displayed.

**10-4** Press the Cancel button twice. The Basic screen returns.

# 11. Clock & Calendar

**11-1** Press the Menu/Enter button in the Basic screen. The Main menu is displayed.

**<Basic screen>**

Press the Menu/Enter button.

**11-2** Select **Clock & Calendar** and press the Menu/Enter button. The "Clock & Calendar" menu is displayed.

**<Main menu>**

Press the Menu/Enter button.

**11-3** Select **Date & Time** and press the Menu/Enter button. The "Date & Time" screen is displayed.

**11-3**

Press the Menu/Enter button.

**11-4** Select the "Year", "Month", "Day" and time by using the ◀▶ (Left/Right) buttons and change the value by using the ▲▼ (Up/Down) buttons. When the buttons are pressed and held, the values change continuously.

**11-4**

Press the Menu/Enter button.

**11-5** Press the Menu/Enter button. The confirmation screen is displayed.

**NOTE**

The day of the week is set automatically.

**11-6** Select **Yes** and press the Menu/Enter button. The settings are confirmed and the Basic screen returns.

**11-6**

Press the Menu/Enter button.

**<Basic screen>**

**NOTE**

If a power outage lasts longer than 48 hours, the time is reset and needs to be set again.

## 12. Language

**12-1** Press the Menu/Enter button in the Basic screen. The Main menu is displayed.

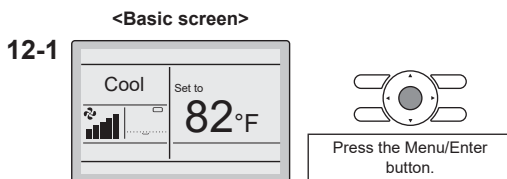

**12-2** Select **Language** and press the Menu/Enter button. The "Language" screen is displayed.

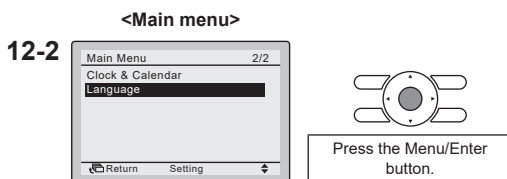

**12-3** Press the ▲▼ (Up/Down) buttons to select the preferred language (English, French or Spanish) and press the Menu/Enter button. The settings are confirmed and the Basic screen returns.

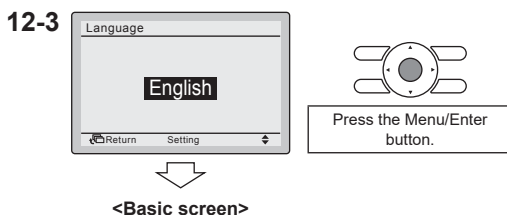

# 13. Prohibit Buttons

- Restriction of the number of operable buttons.

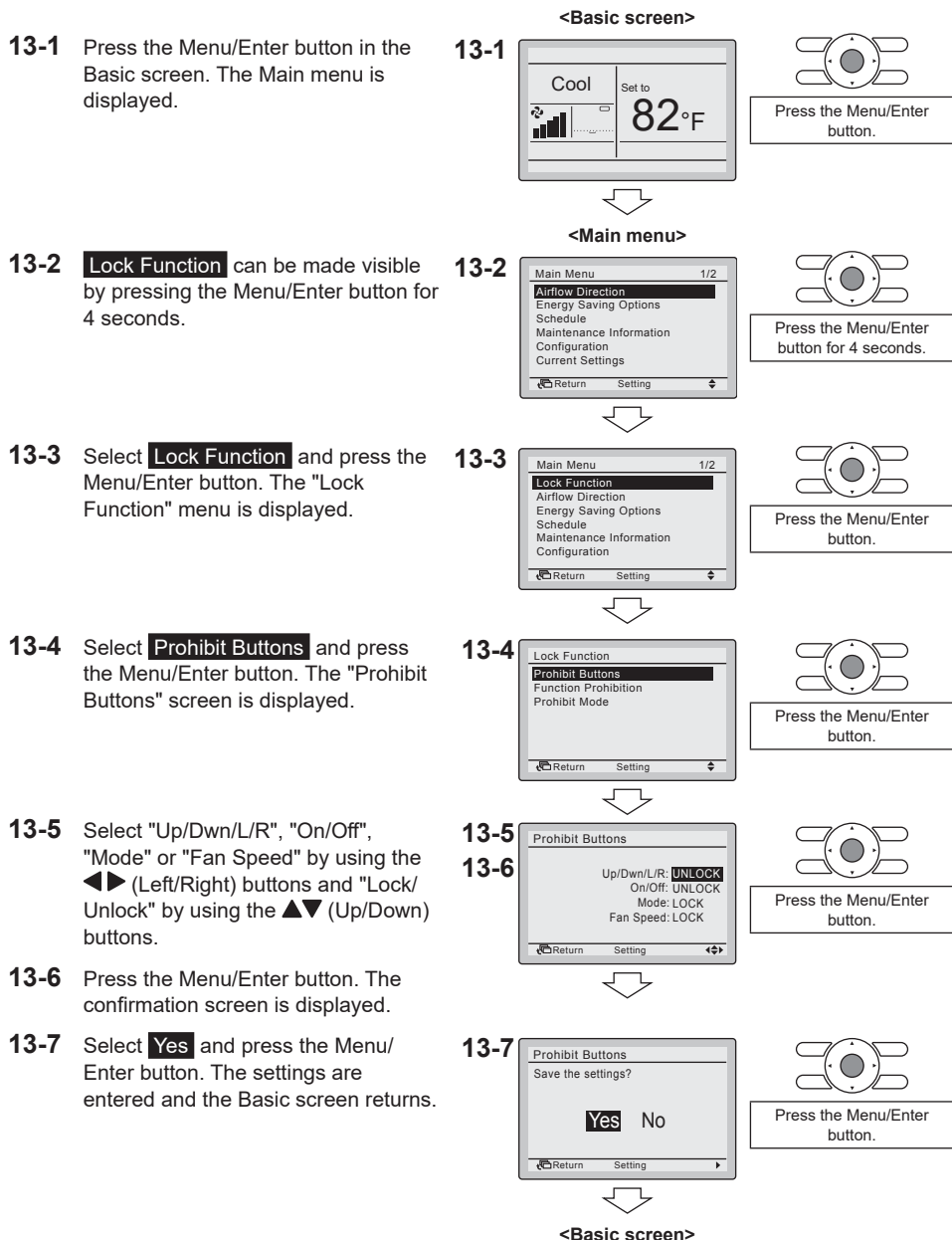

# 14. Function Prohibition

- Restriction of the number of operable functions.

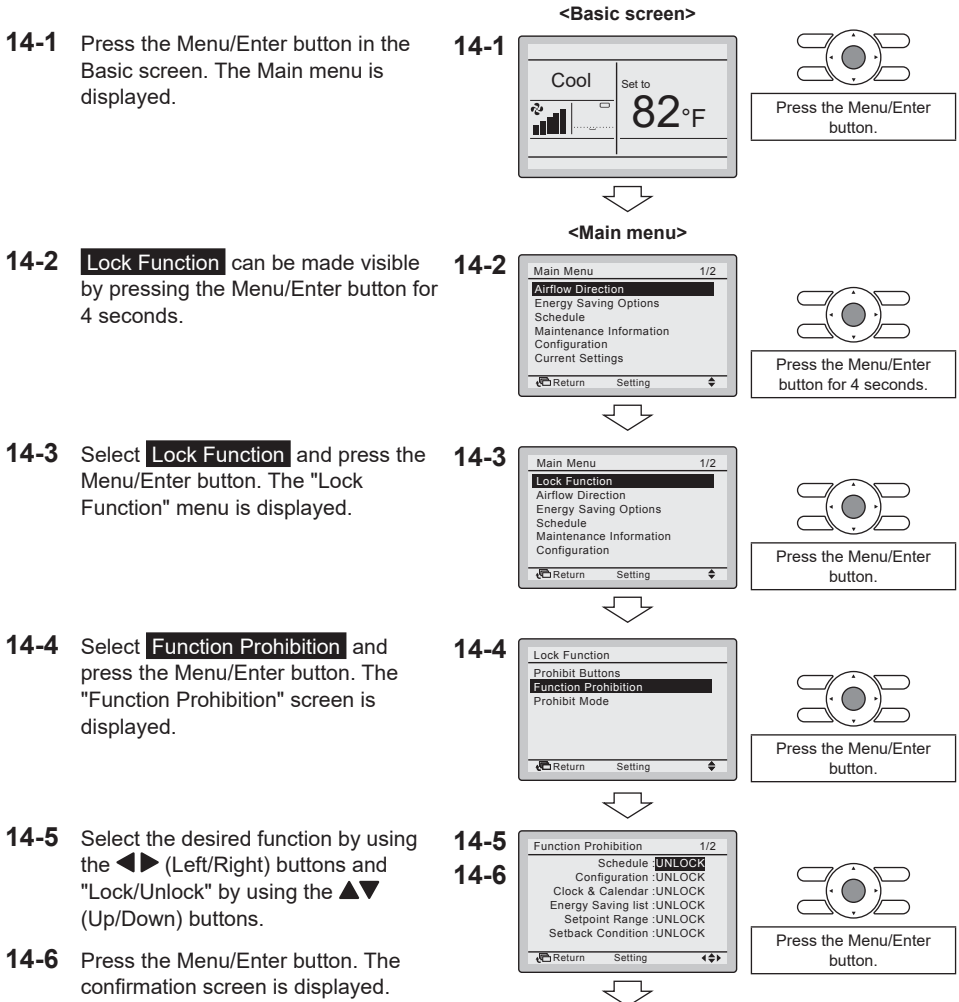

**14-7** Select **Yes** and press the Menu/Enter button. The settings are entered and the Basic screen returns.

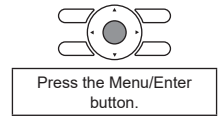
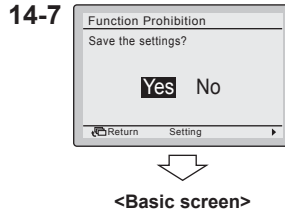

## NOTE

- When a function is prohibited, the  icon will be displayed next to the function.

# 15. Prohibit Mode

- Restriction of the number of operable modes.

**15-1** Press the Menu/Enter button in the Basic screen. The Main menu is displayed.

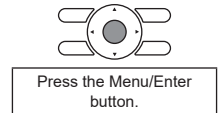
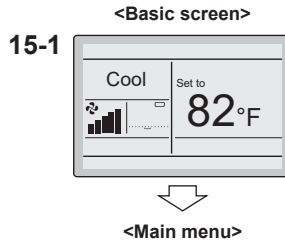

**15-2** **Lock Function** can be made visible by pressing the Menu/Enter button for 4 seconds.

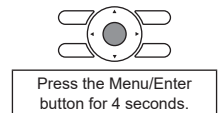
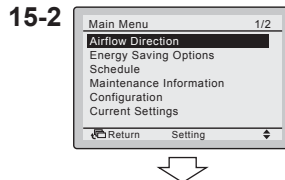

**15-3** Select **Lock Function** and press the Menu/Enter button. The "Lock Function" menu is displayed.

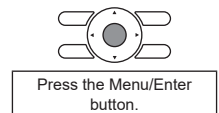
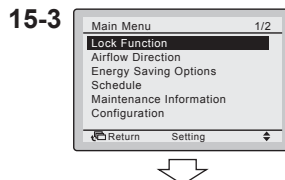

**15-4** Select **Prohibit Mode** and press the Menu/Enter button. The "Prohibit Mode" screen is displayed.

**15-4**

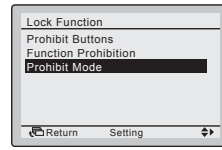

Press the Menu/Enter button.

**15-5** Select "Fan", "Cool", "Heat", "Auto" or "Dry" using the ◀▶ (Left/Right) buttons and "Enable/Disable" the selected mode by using the ▲▼ (Up/ Down) buttons.

**15-5**

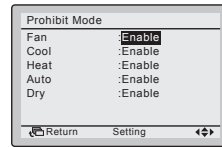

Press the Menu/Enter button.

**15-6** Press the Menu/Enter button. The confirmation screen is displayed.

**15-7**

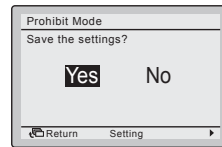

Press the Menu/Enter button.

<Basic screen>

## NOTE

- When the currently active mode is locked, this mode will still be active upon returning to the Basic screen. Only when the mode is changed, the disabled mode will not be available anymore. When all modes are locked, it is not possible to change to another mode other than the currently active mode.

**DAIKIN COMFORT TECHNOLOGIES NORTH AMERICA, INC.**

19001 Kermier Road

Waller, TX 77484

<https://www.northamerica-daikin.com>



The two-dimensional bar code is a manufacturing code.

3P754595-1 M23B265 (2404) HT