

SPW-01 SINGLE POINT WIRING KIT INSTALLATION INSTRUCTIONS

© 2025 Daikin Comfort Technologies Manufacturing, Inc.
19001 Kermier Rd., Waller, TX 77484
www.daikincomfort.com
P/N: IO-720B Date: July 2025

DESCRIPTION

The SPW-01 single point kit creates one power supply for heater kits with two circuit breakers. It is compatible with heater kits HKR15C, HKR-20C, HKR-21C, HKSC15XA, HKSC15XB, HKSC19CA, HKSC19CB, HKSC20DA, HKSC20DB, HKTSD15A, HKTSD15XB, HKTSD19CA, HKTSD19CB, HKTSD20DA, HKTSD20DB, HKTSD25DA and HKTSD25DB when installed in a single-piece Goodman® or Amana® brand air handler or modular blower.

The kit includes:

- (1) Power block
- (1) Mounting bracket
- (4) Wires
- (2) #6 Pan head screws
- (2) #10 self drilling screws, and
- (1) Power block cover with two screws in a bag

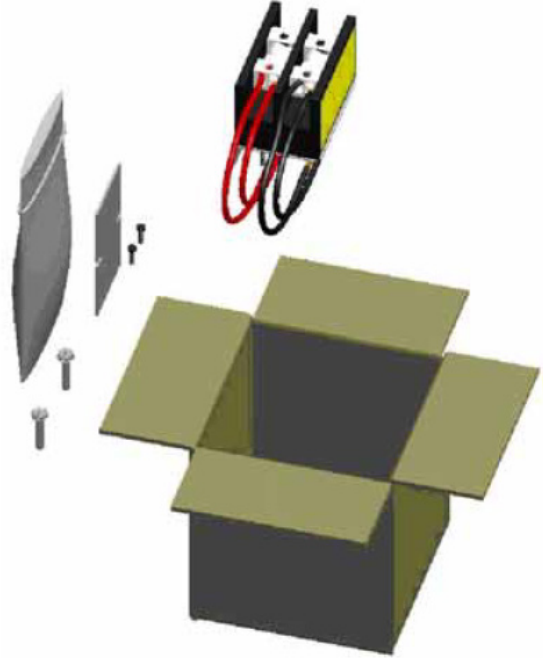

WARNING

ONLY PERSONNEL THAT HAVE BEEN TRAINED TO INSTALL, ADJUST, SERVICE, MAINTENANCE OR REPAIR (HEREINAFTER, "SERVICE") THE EQUIPMENT SPECIFIED IN THIS MANUAL SHOULD SERVICE THE EQUIPMENT.

THIS EQUIPMENT IS NOT INTENDED FOR USE BY PERSONS (INCLUDING CHILDREN) WITH REDUCED PHYSICAL, SENSORY OR MENTAL CAPABILITIES, OR LACK OF EXPERIENCE AND KNOWLEDGE, UNLESS THEY HAVE BEEN GIVEN SUPERVISION OR INSTRUCTION CONCERNING USE OF THE APPLIANCE BY A PERSON RESPONSIBLE FOR THEIR SAFETY.

CHILDREN SHOULD BE SUPERVISED TO ENSURE THAT THEY DO NOT PLAY WITH THE EQUIPMENT.

THE MANUFACTURER WILL NOT BE RESPONSIBLE FOR ANY INJURY OR PROPERTY DAMAGE ARISING FROM IMPROPER SUPERVISION, SERVICE OR SERVICE PROCEDURES. IF YOU SERVICE THIS UNIT, YOU ASSUME RESPONSIBILITY FOR ANY INJURY OR PROPERTY DAMAGE WHICH MAY RESULT. IN ADDITION, IN JURISDICTIONS THAT REQUIRE ONE OR MORE LICENSES TO SERVICE THE EQUIPMENT SPECIFIED IN THIS MANUAL, ONLY LICENSED PERSONNEL SHOULD SERVICE THE EQUIPMENT. IMPROPER SUPERVISION, INSTALLATION, ADJUSTMENT, SERVICING, MAINTENANCE OR REPAIR OF THE EQUIPMENT SPECIFIED IN THIS MANUAL, OR ATTEMPTING TO INSTALL, ADJUST, SERVICE OR REPAIR THE EQUIPMENT SPECIFIED IN THIS MANUAL WITHOUT PROPER SUPERVISION OR TRAINING MAY RESULT IN PRODUCT DAMAGE, PROPERTY DAMAGE, PERSONAL INJURY OR DEATH.



WARNING

DO NOT BYPASS SAFETY DEVICES.

ATTENTION INSTALLING PERSONNEL

As a professional installer you have an obligation to know the product better than the customer. This includes all safety precautions and related items.

Prior to actual installation, thoroughly familiarize yourself with this instruction manual. Pay special attention to all safety warnings. Often during installation or repair it is possible to place yourself in a position which is more hazardous than when the unit is in operation.

Remember, it is your responsibility to install the product safely and to know it well enough to be able to instruct a customer in its safe use. Safety is a matter of common sense...a matter of thinking before acting. Most dealers have a list of specific good safety practices... follow them. The precautions listed in this installation manual are intended as supplemental to existing practices. However, if there is a direct conflict between existing practices and the content of this manual, the precautions listed here take precedence.

19001 Kermier Rd. Waller, Tx 77484



www.daikincomfort.com • www.goodmanmfg.com • www.amana-hac.com

Amana is a registered trademark of Maytag Corporation or its related companies and is used under license. All rights reserved.

© 2025 Daikin Comfort Technologies Manufacturing, Inc.



HKR MODELS

	WARNING
HIGH VOLTAGE DISCONNECT ALL POWER BEFORE SERVICING OR INSTALLING THIS KIT. MULTIPLE POWER SOURCES MAY BE PRESENT. FAILURE TO DO SO MAY CAUSE PROPERTY DAMAGE, PERSONAL INJURY OR DEATH.	
	

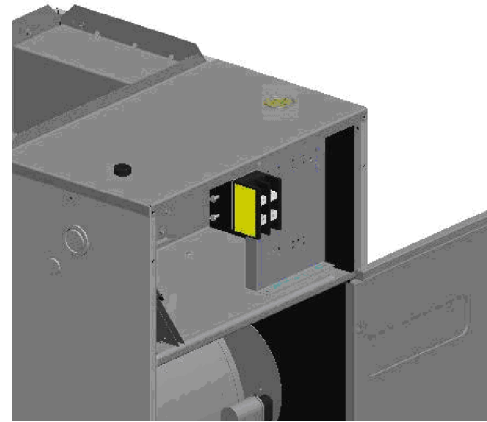

INSTALLATION INSTRUCTIONS

NOTE: A compatible heater kit must be installed **PRIOR** to installing this kit. If the circuit breaker plate is not installed, please refer to your heater kit installation instructions on how to install the circuit breaker plate to the chassis.

1. Turn OFF the main power supply and set the circuit breakers to the OFF position.
2. Remove the unit access panel to expose the control box.

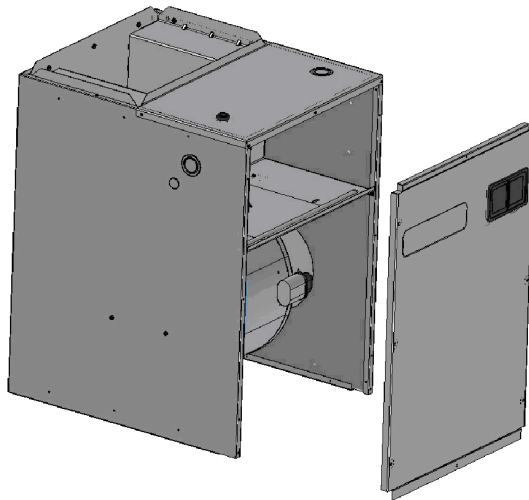

3. Identify if the circuit breaker plate comes with two pre-drilled holes or one pre-drilled hole on the left side of the plate. If the plate has two pre-drilled holes, skip the next step.

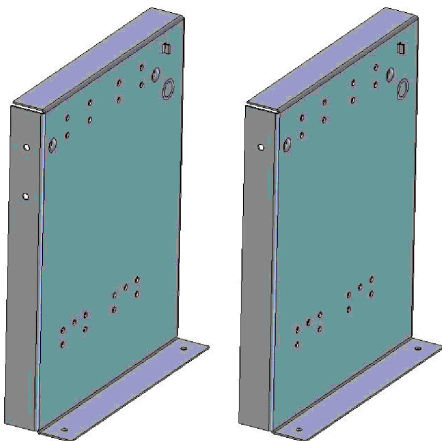

4. Using the supplied mounting bracket as a template, drill a 0.125" pilot hole in the circuit breaker plate.
5. Install the supplied mounting bracket and power block to the circuit breaker plate using the enclosed #10 screws. Torque screws to 19 in-lbs.

6. Install the four SPW-01 kit wires to the circuit breaker lugs and torque lug screws to 35 in-lbs. Ensure all wires are tucked inside the control box.

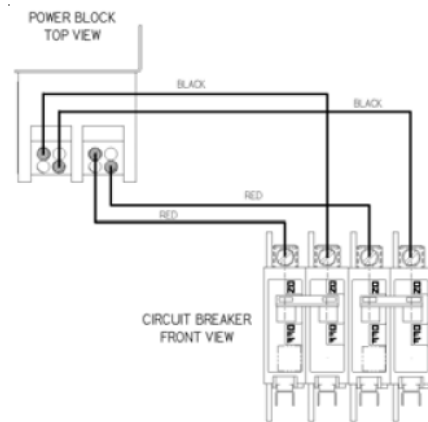

7. Secure the power supply wires to the line side of the power block and torque screws to 120 in-lbs. **Note:** Attach supply ground wire to ground lug on breaker panel 2AWG MAX.
8. Using the screws enclosed in the power block cover bag, install the power block cover to the power block.

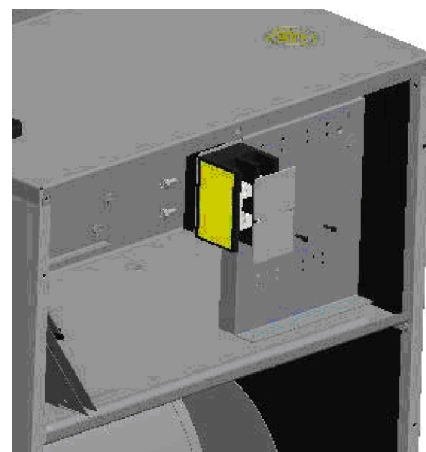

9. Reinstall the access panel removed in Step 2. Ensure the panel edge does not cut into the wire insulation.
10. Turn ON the main power supply and set the circuit breakers to the ON position.
11. Set the room thermostat to call for emergency heat or auxiliary heat. Verify the blower is running after a short delay and there is warm air flow from the vents.

HKS AND HKTS MODELS



WARNING

HIGH VOLTAGE

DISCONNECT ALL POWER BEFORE SERVICING OR INSTALLING THIS KIT. MULTIPLE POWER SOURCES MAY BE PRESENT. FAILURE TO DO SO MAY CAUSE PROPERTY DAMAGE, PERSONAL INJURY OR DEATH.



INSTALLATION INSTRUCTIONS

NOTE: A compatible heater kit must be installed **PRIOR** to installing this kit. If the circuit breaker plate is not installed, please refer to your heater kit installation instructions on how to install the circuit breaker plate to the chassis.

1. Turn OFF the main power supply and set the circuit breakers to the OFF position.
2. Remove the unit access panel to expose the control box.

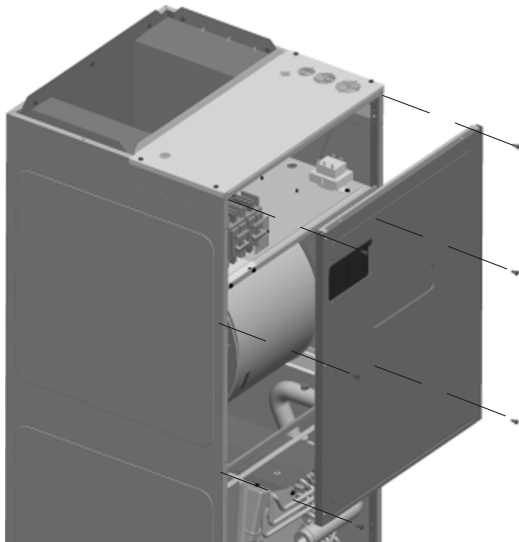

3. Identify if the circuit breaker plate comes with two pre-drilled holes or one pre-drilled hole on the right side of the plate. If the plate has two pre-drilled holes, skip the next step.

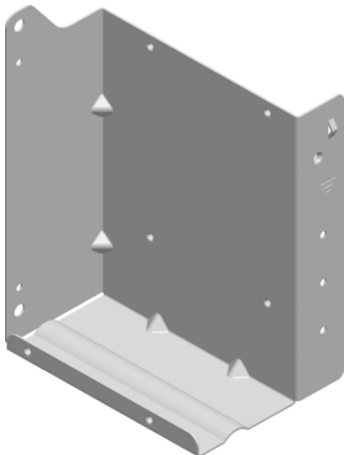

4. Using the supplied mounting bracket as a template, drill a 0.125" pilot hole in the circuit breaker plate.
5. Install the supplied mounting bracket and power block to the circuit breaker plate using the enclosed #10 screws. Torque screws to 19 in-lbs.

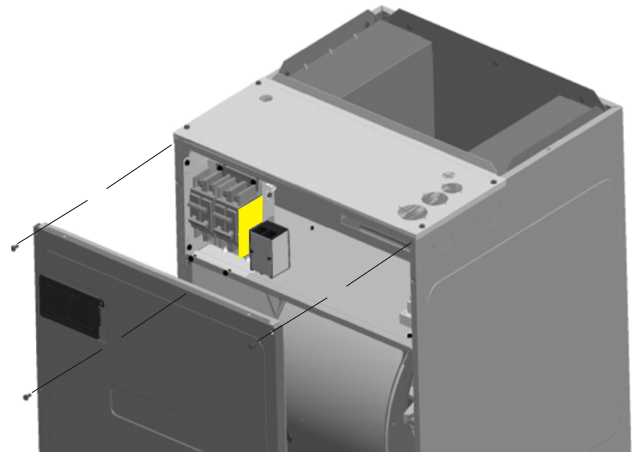

6. Install the four SPW-01 kit wires to the circuit breaker lugs and torque lug screws to 35 in-lbs. Ensure all wires are tucked inside the control box.

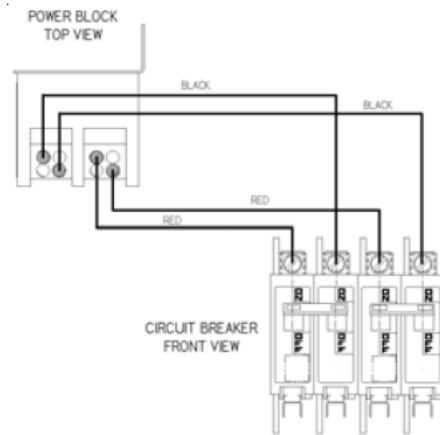

7. Secure the power supply wires to the line side of the power block and torque screws to 120 in-lbs. Note: Attach supply ground wire to ground lug on breaker panel 2AWG MAX.
8. Using the screws enclosed in the power block cover bag, install the power block cover to the power block.

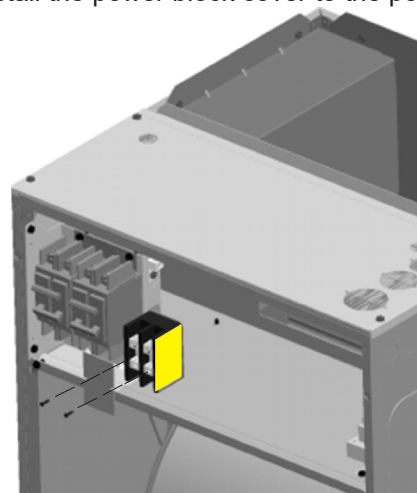

9. Reinstall the access panel removed in Step 2. Ensure the panel edge does not cut into the wire insulation.
10. Turn ON the main power supply and set the circuit breakers to the ON position.
11. Set the room thermostat to call for emergency heat or auxiliary heat. Verify the blower is running after a short delay and there is warm air flow from the vents.

CUSTOMER FEEDBACK

We are very interested in all product comments.

Please fill out the feedback form on one of the following links:

Daikin Products: (<https://daikincomfort.com/contact-us>)

Goodman® Brand Products: (<http://www.goodmanmfg.com/about/contact-us>).

Amana® Brand Products: (<http://www.amana-hac.com/about-us/contact-us>).

You can also scan the QR code on the right for the product brand you purchased to be directed to the feedback page.



DAIKIN



GOODMAN® BRAND



AMANA® BRAND

NOTE: SPECIFICATIONS AND PERFORMANCE DATE LISTED HEREIN ARE SUBJECT TO CHANGE WITHOUT NOTICE.

Visit our website at www.goodmanmfg.com or www.amana-hac.com for information on:

- Products
- Warranties
- Customer Services
- Parts
- Contractor Programs and Training
- Financing Options

19001 Kermier Rd., Waller, TX 77484

www.daikincomfort.com • www.goodmanmfg.com • www.amana-hac.com

Amana is a registered trademark of Maytag Corporation or its related companies and is used under license. All rights reserved.

© 2025 Daikin Comfort Technologies Manufacturing, Inc.