



# REPAIR PARTS

---

## AXV/AZV[7,9]SA Enhance and Cold Climate AC/HP

AXV9SA6010AA

AZV7SA6010AA

AZV9SA241CAA

AZV9SA361CAA

Amana® is a registered trademark of Maytag Corporation or its related companies and is used under license. All rights reserved.

This manual is to be used by qualified technicians only.

© 2025 Goodman Company, L.P. ♦ 19001 Kermier Rd. ♦ Waller, TX 77484

# Important Information

---

## Index

Functional Parts List .....	3
Illustration and Parts .....	4 - 5

*Views shown are for parts illustrations only, not servicing procedures.*

### Text Codes:

AR - As Required

NA - Not Available

NS - Not Shown

00000000 - See Note

QTY - Quantity Example (QTY 3) (If Quantity not shown, Quantity = 1)

M - Model Example (M1) (If M Code not shown, then part is used on all Models)

### Expanded Model Nomenclature:

Example
M1 - Model#1
M2 - Model#2
M3 - Model#3

Goodman Company, L.P. is not responsible for personal injury or property damage resulting from improper service. Review all service information before beginning repairs.

Warranty service must be performed by an authorized technician, using authorized factory parts. If service is required after the warranty expires, Goodman Company, L.P. also recommends contacting an authorized technician and using authorized factory parts.

Goodman Company, L.P. reserves the right to discontinue, or change at any time, specifications or designs without notice or without incurring obligations.

For assistance within the U.S.A. contact:

Homeowner Support  
Goodman Company, L.P.  
19001 Kermier Road  
Waller, Texas 77484  
877-254-4729-Telephone  
713-863-2382-Facsimile

For assistance outside the U.S.A. contact:

International Division  
Goodman Company, L.P.  
19001 Kermier Road  
Waller, Texas 77484  
713-861-2500-Telephone  
713-863-2382-Facsimile

# Functional Parts

## Part

## No: Description:

---

2564683	DC FAN MOTOR (QTY 2)
2543717	HIGH PRESSURE SWITCH
2545134	PRESSURE SENSOR
2564668	PRESSURE SENSOR
2564672	PRINTED CIRCUIT BOARD ASSY.
2564674	PRINTED CIRCUIT BOARD ASSY. (FAN PCB)
2564665	SWING COMPRESSOR

### Expanded Model Nomenclature

M1 - AXV9SA6010AA

M2 - AZV7SA6010AA

M3 - AZV9SA241CAA

M4 - AZV9SA361CAA

# AZV9SA[24,36]1CAA [AZV7SA,AXV9SA]6010AA

AZV9SA241CAA / AZV9SA361CAA / AZV7SA6010AA / AXV9SA6010AA

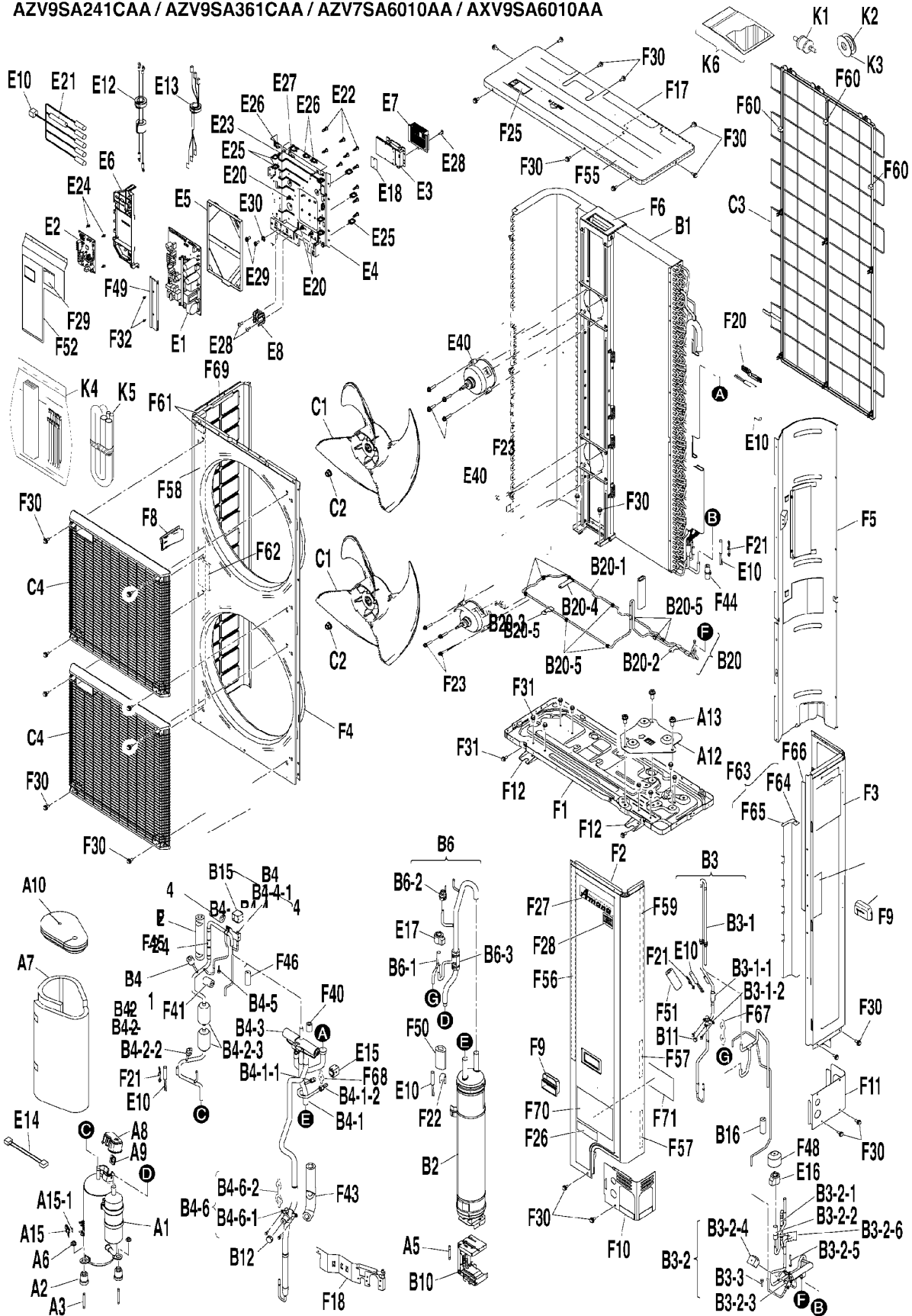

Picture Key	
Ref #	Picture #
1	A1
2	A10
3	A12
4	A13
5	A15
6	A15-1
7	A2
8	A3
9	A5
10	A6
11	A7
12	A8
13	A9
14	B1
15	B10
16	B11
17	B12
18	B15
19	B16
20	B2
21	B20
22	B20-1
23	B20-2
24	B20-3
25	B20-4
26	B20-5
27	B3
28	B3-1
29	B3-1-1
30	B3-1-2
31	B3-2
32	B3-2-1
33	B3-2-2
34	B3-2-3
35	B3-2-4
36	B3-2-5
37	B3-2-6
38	B3-3
39	B4
40	B4-1
41	B4-1-1
42	B4-1-2
43	B4-2
44	B4-2-1
45	B4-2-2
46	B4-2-3
47	B4-2-4
48	B4-3
49	B4-4
50	B4-4-1
51	B4-5
52	B4-6
53	B4-6-1
54	B4-6-2
55	B6
56	B6-1
57	B6-2
58	B6-3
59	C1
60	C2
61	C3
62	C4
63	E1
64	E10
65	E13
66	E13
67	E14
68	E15
69	E16
70	E17
71	E18
72	E2
73	E20
74	E21
75	E22
76	E23
77	E24
78	E25
79	E26
80	E27
81	E28
82	E29
83	E3
84	E30
85	E4
86	E40
87	E5
88	E6
89	E7
90	E8
91	F1
92	F10
93	F11
94	F12
95	F17
96	F18
97	F2
98	F20
99	F21
100	F22
101	F23
102	F24
103	F25
104	F26
105	F27
106	F28
107	F3
108	F30
109	F31
110	F32
111	F4
112	F40
113	F41
114	F42
115	F43
116	F44
117	F45
118	F46
119	F47
120	F48
121	F49
122	F5
123	F50
124	F51
125	F52
126	F53
127	F54
128	F55
129	F56
130	F57
131	F58
132	F59
133	F6
134	F60
135	F61
136	F62
137	F63
138	F64
139	F65
140	F66
141	F67
142	F68
143	F69
144	F70
145	F9
146	K1
147	K2
148	K3
149	K4
150	K5
151	K6

# AZV9SA[24,36]1CAA [AZV7SA,AXV9SA]6010AA

Ref. Part No: No:	Description:	Ref. Part No: No:	Description:
<i>Image 1:</i>		<i>Image 1:</i>	
1	2564665 SWING COMPRESSOR	58	1831478 WEIGHT
2	4017933 SOUND ABSORBING ASSY.	59	1864005 PROPELLER FAN (QTY 2)
3	2564687 COMPRESSOR STAND	60	847003J LOCK NUT/ FAN (QTY 2)
4	1859957 HEX HEAD SCREW (QTY 3)	61	4010670 AIR SUCTION GRILLE
5	2433017 RETAINER ASSY.	62	2564688 DISCH. GRILLE ASSY. (QTY 2)
6	2428527 RADIATION SHEET	63	2564672 PRINTED CIRCUIT BOARD ASSY.
7	2274364 RUBBER VIBRATION ISOLATOR ASSY. (QTY 3)	64	2564677 THERMISTOR ASSY.
8	2119809 COMPRESSOR MOUNTING BOLT (QTY 3)	65	2564678 WIRE HARNESS ASSY. (POWER)
9	065023J BOLT FOR COMPRESSOR	66	2564682 WIRE HARNESS ASSY. (COMP.)
10	4010410 WASHER (NUT WITH WASHER) (QTY 3)	67	2565375 WIRE HARNESS ASSY. (PCB-OL)
11	2564666 COMP. SOUNDPROOF	68	2564679 FOUR WAY VALVE COIL ASSY.
12	2425597 TERMINAL COVER	69	2564680 COIL/ ELECTRONIC EXP. VALVE
13	040139J RUBBER BUSH/ LEAD WIRE	70	2564681 COIL/ ELECTRONIC EXP. VALVE
14	2564667 HEAT EXCHANGER ASSY.	71	7009590 INSULATION SHEET
15	4008212 MOUNTING PLATE	72	2564673 PRINTED CIRCUIT BOARD ASSY.
16	2279028 DUST CAP	73	2565041 LOCKING CARD SPACER (FGS) (QTY 3)
17	2295099 CAP STOP VALVE	74	2565364 CUSHION MATERIAL
18	2564671 SOLENOID VALVE COIL	75	2560889 LOCKING CARD SPACER (QTY 12)
19	2565040 THERMAL INSULATION TUBE	76	1233757 LOCKING CARD SPACER (QTY 2)
20	2565357 ACCUMULATOR ASSY.	77	2565042 LOCKING CARD SPACER (QTY 4)
21	2565358 REFRIGERANT PIPE ASSY. (HOT GAS)	78	352004 WIRE CLIP (QTY 8)
22	2565359 REFRIGERANT PIPE ASSY.	79	094708J EDGE SADDLE (QTY 3)
23	2565360 MOUNTING PLATE	80	099951J EDGE SADDLE
24	2565361 MOUNTING PLATE	81	827920J TAPPING SCREW (QTY 3)
25	2565362 MOUNTING PLATE	82	119839J TAPPING SCREW (QTY 2)
26	2565363 PIPING FIXTURE ASSY. (QTY 9)	83	2564674 PRINTED CIRCUIT BOARD ASSY. (FAN PCB)
27	2565353 ELECTRONIC EXP. VALVE ASSY.	84	071124J CUP WASHER
28	2565354 ELECTRONIC EXP. VALVE ASSY. (2)	85	2564675 EL. COMPO. MOUNTING PLATE
29	2397382 FILTER	86	2564683 DC FAN MOTOR (QTY 2)
30	2564776 STOP VALVE	87	2560882 PCB MOUNTING PLATE (FRONT)
31	2565355 ELECTRONIC EXP. VALVE ASSY. (5)	88	2564676 PCB MOUNTING PLATE (CT MODULE)
32	038621J CHECK VALVE	89	2541077 EL. COMPO. BOX COVER
33	2204606 BODY/ ELECTRONIC EXP. VALVE	90	2425751 TERMINAL BLOCK
34	2165965 BODY/ SOLENOID VALVE	91	4010673 BOTTOM FRAME
35	2564669 SOLENOID VALVE COIL	92	2531804 COVER (FRONT)
36	008529J STRAINER (FOR REF.)	93	151774J COVER/ PIPING (REAR)
37	2565376 SEALING MATERIAL	94	4009049 ANCHOR PLATE (QTY 2)
38	111167J STRAINER	95	4010471 TOP PLATE
39	2565347 FOUR WAY VALVE ASSY.	96	2564686 STOP VALVE MOUNTING PLATE
40	2565350 SUCTION PIPE ASSY.	97	4010674 FRONT PLATE (2)
41	094867J SERVICING PORT ASSY.	98	2546498 THERMISTOR FIXING PLATE
42	7009455 FUSIBLE PLUG ASSY.	99	042396J FITTING SPRING/ THERMISTOR (QTY 3)
43	2565351 DISCHARGE PIPE ASSY.	100	2031411 FEELER BULB CLAMP
44	2564668 PRESSURE SENSOR	101	2120405 HEX TAPPING SCREW (3) (QTY 8)
45	2543717 HIGH PRESSURE SWITCH	102	2564156 LABEL
46	170153J MUFFLER ASSY. (QTY 2)	103	4023075 CAUTION LABEL (ROTATING)
47	107638J CHECK VALVE	104	2548909 BRAND NAME LABEL(Amana)
48	2564690 FOUR WAY VALVE BODY	105	4015906 LABEL (INVERTER R32)
49	2565352 REFRIGERANT PIPE ASSY. (HOT GAS)	106	NA CAUTION LABEL (ELECTRIC SHOCK)
50	2165965 BODY/ SOLENOID VALVE	107	4010675 SIDE PLATE (RIGHT)
51	111167J STRAINER	108	049594J HEX HEAD TAPPING SCREW (QTY 36)
52	2565348 REFRIGERANT PIPE ASSY. (GAS SIDE)	109	131453J TRUSS HEAD TAPPING SCREW (QTY 16)
53	2564775 STOP VALVE	110	4016867 HEX BOLT (QTY 2)
54	2565349 SILICONE RUBBER SHEET (SNAP)	111	4010676 FRONT PLATE (1)
55	2565356 SUCTION PIPE ASSY. (2)	112	2565043 THERMAL INSULATION TUBE
56	2233628 BODY/ ELECTRONIC EXP. VALVE	113	2564691 THERMAL INSULATION TUBE
57	2545134 PRESSURE SENSOR	114	2565044 THERMAL INSULATION TUBE

# AZV9SA[24,36]1CAA [AZV7SA,AXV9SA]6010AA

Ref. Part No:	Part No:	Description:	Ref. Part No:	Part No:	Description:
<i>Image 1:</i>					
115	2565045	THERMAL INSULATION TUBE			
116	2565046	THERMAL INSULATION TUBE			
117	2565047	THERMAL INSULATION TUBE			
118	2565040	THERMAL INSULATION TUBE			
119	4017929	PROTECTION CAP			
120	2564689	COVER (JACKET)			
121	2564684	PARTITION PLATE ASSY.			
122	2556773	THERMAL INSULATION TUBE			
123	2558375	THERMAL INSULATION TUBE			
124	2565048	INSULATION SHEET			
125	1831632	TOP PLATE SEALING MATERIAL (1)			
126	144658J	SEALING MATERIAL (FRONT PLATE 2)			
127	1955040	SEALER (FRONT PLATE 2) (QTY 2)			
128	2565365	SEALING MATERIAL			
129	4001092	SEALER (SIDE PLATE 1)			
130	2564685	FAN MOTOR STAND ASSY.			
131	4010682	SEALING MATERIAL (SIDE PLATE) (QTY 3)			
132	162762J	SEALING MATERIAL (QTY 2)			
133	4010681	SEALER			
134	4010683	SEALING MATERIAL (SIDE PLATE)			
135	2565366	SEALING MATERIAL (1) (SIDE PLATE)			
136	2565367	SEALING MATERIAL (2) (SIDE PLATE)			
137	2540378	SEALING MATERIAL (SIDE PLATE)			
138	2565368	SILICONE RUBBER SHEET (SNAP)			
139	2565369	SILICONE RUBBER SHEET (SNAP)			
140	4013048	SEALING MATERIAL			
141	2565370	CAUTION LABEL (R32)			
142	2565371	CAUTION LABEL (R32)			
143	2565372	CAUTION LABEL (R32)			
144	4010680	HANDLE (LEFT)			
145	092045J	HANDLE (QTY 2)			
146	2545851	FILTER DRIER			
147	1997431	CONDUIT MOUNTING PLATE (QTY 2)			
148	1997448	CONDUIT MOUNTING PLATE (QTY 2)			
149	2565250	PUTTY ASSY.			
150	2565373	ELECTRIC INSULATION TUBE ASSY.			
151	2494067	GREASE ASSY.			

## Expanded Model Nomenclature

M1 - AXV9SA6010AA
M2 - AZV7SA6010AA
M3 - AZV9SA241CAA
M4 - AZV9SA361CAA